

IDENTIFIED HAZARDS	
1.	GAS MAIN SITUATED BELOW. CARE TO BE TAKEN DURING EXCAVATION.
2.	WATER PIPE SITUATED BELOW, CARE TO BE TAKEN DURING EXCAVATION.
3.	ELECTRIC CABLE SITUATED BELOW. CARE TO BE TAKEN DURING EXCAVATION.
4.	EXCAVATION AREA IS ADJACENT TO A NUMBER OF TAPS/METERS/ ACCESS POINTS. CARE TO BE TAKEN DURING WORKS TO ENSURE NO DAMAGE TO EXISTING UTILITIES STRUCTURES.
5.	EXCAVATION AREA IS NEAR TO BASEMENT (CELLAR) AREA. CARE TO BE TAKEN DURING WORKS TO ENSURE NO DAMAGE TO EXISTING BASEMENT STRUCTURE.

TO BE READ IN CONJUNCTION WITH:
 DWG No. 1367-SY-GA-301
 DWG No. 1367-SY-GA-302
 DWG No. 1367-SY-GA-303
 DWG No. 1367-SY-GA-304

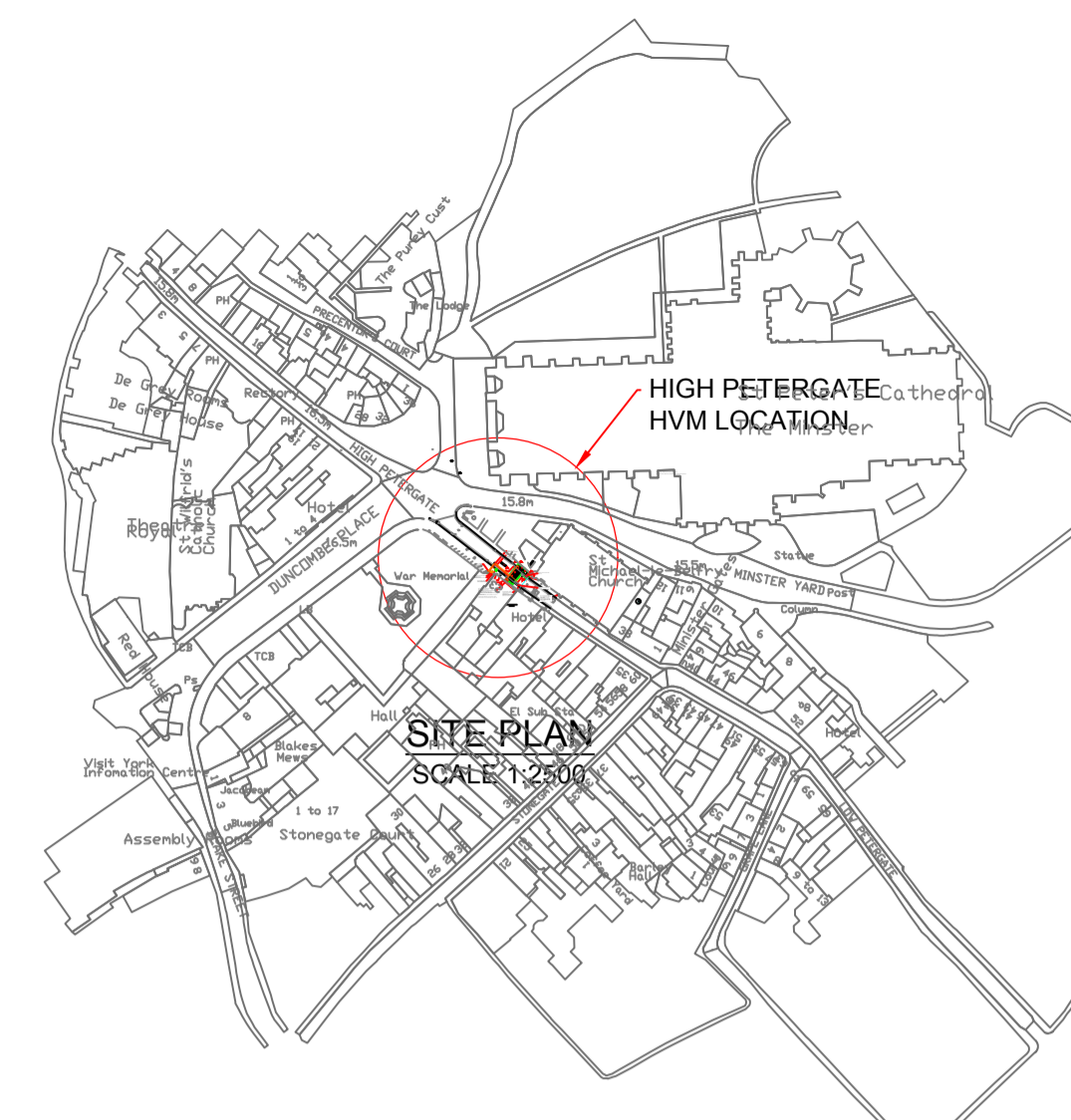

NOTES

GENERAL

- DO NOT SCALE FROM THIS DRAWING.
- ANY QUERIES ARE TO BE REFERRED BACK TO THE ENGINEER FOR CLARIFICATION.

CONCRETE

- ALL CONCRETE IN ACCORDANCE WITH BS 8500.
- CONCRETE DESIGNATED MIX: AS PER BOLLARD MANUFACTURERS SPECIFICATION. NO ADMIXTURE IS TO BE USED WITHOUT THE ENGINEERS PERMISSION.
- SHOULD THE AIR TEMPERATURE RISE ABOVE 30°C OR FALL BELOW 5°C, SPECIAL PRECAUTIONS ARE TO BE TAKEN, ALL TO ENGINEER'S APPROVAL.
- ANY SOFT SPOTS WITHIN THE GROUND REMOVED AND BACKFILLED WITH TYPE 1 FILL MATERIAL. PRIOR TO PLACING OF BLINDING CONCRETE. FILL MATERIAL WELL COMPACTED IN 300mm LAYERS.
- CURING TO BE DONE FOR AT LEAST 7 DAYS PRIOR TO ANY LOADING BEING APPLIED TO THE FOUNDATION.
- REINFORCEMENT BARS TO BE HIGH YIELD STEEL TO CURRENT BS 4449, FABRIC REINFORCEMENT TO BS 4483.
- REINFORCEMENT SCHEDULING TO BS 8666.
- REINFORCEMENT AS PER BOLLARD MANUFACTURERS SPECIFICATION.
- REINFORCEMENT LAP LENGTHS ARE TO BE A MINIMUM OF 72 D UNLESS OTHERWISE NOTED.
- ALL MATERIAL AND WORKMANSHIP IN ACCORDANCE WITH RECOMMENDATIONS OF BS 8110.

BOLLARDS

- PRODUCTS TO BE INSTALLED IN ACCORDANCE WITH MANUFACTURERS GUIDELINES AND REQUIREMENTS.
- FOUNDATIONS PROVIDED IN ACCORDANCE WITH MANUFACTURERS RECOMMENDATIONS.
- ALL BOLLARD PRODUCTS TO BE SUCCESSFULLY IMPACT TESTED TO PAS 68 / IWA 14
- THE GAP BETWEEN BOLLARD CORES SHALL BE NO MORE THAN 1200mm AT 600mm ABOVE FINISHED GROUND LEVEL.
- SHROUD MATERIAL: STAINLESS STEEL
- SHROUD FINISH TO BE AGREED WITH THE CLIENT
- SHROUD TO HAVE 50mm REFLECTIVE BAND

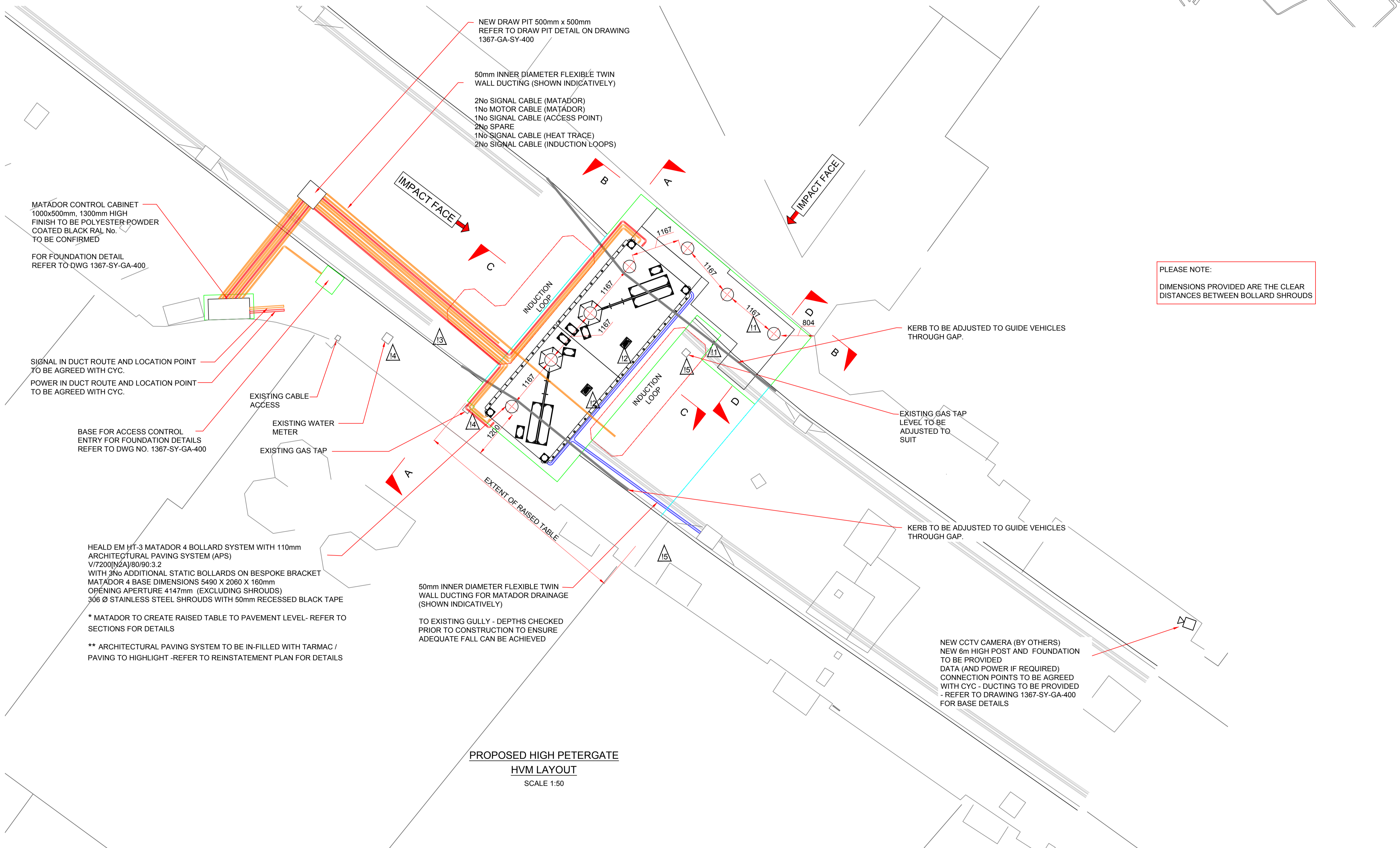

PLEASE NOTE:
 DIMENSIONS PROVIDED ARE THE CLEAR DISTANCES BETWEEN BOLLARD SHROUDS

MATADOR CONTROL CABINET
 1000x500mm, 1300mm HIGH
 FINISH TO BE POLYESTER POWDER
 COATED BLACK RAL No.
 TO BE CONFIRMED
 FOR FOUNDATION DETAIL
 REFER TO DWG NO. 1367-SY-GA-400

SIGNAL IN DUCT ROUTE AND LOCATION POINT
 TO BE AGREED WITH CYC.
 POWER IN DUCT ROUTE AND LOCATION POINT
 TO BE AGREED WITH CYC.

BASE FOR ACCESS CONTROL
 ENTRY FOR FOUNDATION DETAILS
 REFER TO DWG NO. 1367-SY-GA-400

HEALD EM HT-3 MATADOR 4 BOLLARD SYSTEM WITH 110mm
 ARCHITECTURAL PAVING SYSTEM (APS)
 V/7200(N2A)/80/90:3.2
 WITH 3No ADDITIONAL STATIC BOLLARDS ON BESPOKE BRACKET
 MATADOR 4 BASE DIMENSIONS 5490 X 2060 X 160mm
 OPENING APERTURE 4147mm (EXCLUDING SHROUDS)
 306 Ø STAINLESS STEEL SHROUDS WITH 50mm RECESSED BLACK TAPE

* MATADOR TO CREATE RAISED TABLE TO PAVEMENT LEVEL- REFER TO SECTIONS FOR DETAILS
 ** ARCHITECTURAL PAVING SYSTEM TO BE IN-FILLED WITH TARMAC / PAVING TO HIGHLIGHT -REFER TO REINSTATEMENT PLAN FOR DETAILS

50mm INNER DIAMETER FLEXIBLE TWIN
 WALL DUCTING FOR MATADOR DRAINAGE
 (SHOWN INDICATIVELY)
 TO EXISTING GULLY - DEPTHS CHECKED
 PRIOR TO CONSTRUCTION TO ENSURE
 ADEQUATE FALL CAN BE ACHIEVED

NEW CCTV CAMERA (BY OTHERS)
 NEW 6m HIGH POST AND FOUNDATION
 TO BE PROVIDED
 DATA (AND POWER IF REQUIRED)
 CONNECTION POINTS TO BE AGREED
 WITH CYC - DUCTING TO BE PROVIDED
 - REFER TO DRAWING 1367-SY-GA-400
 FOR BASE DETAILS

PROPOSED HIGH PETERGATE
 HVM LAYOUT
 SCALE 1:50

B	10.06.22	TENDER ISSUE	MJH	SLP	
A	01.06.22	TENDER ISSUE	MJH	SLP	
REV	DATE	DESCRIPTION	BY	CHKD	APVD

CONTRACT NAME:
 CITY OF YORK COUNCIL

CLIENT:
 CITY OF YORK COUNCIL

D.J. Goode & Associates Ltd.
Consulting Civil Engineers.
 The Old Control Tower,
 Lavenham Airfield,
 Old Bury Road,
 Alpheton,
 Sudbury, Suffolk,
 CO10 9BT.
 Tel: 01284 827472
 Email: p1@djgoode.co.uk



DRAWN BY:	DATE:	CHECKED BY:	DATE:	APPROVED BY:	DATE:
MJH	08.04.22	SLP	26.04.22		
SIGNED:		SIGNED:		SIGNED:	

DRAWING TITLE:
 HIGH PETERGATE HVM SCHEME
 PROPOSED LAYOUT

SCALE:	DRAWING STATUS:	PROTECTIVE MARKING:
1:50 @ A1	TENDER	
DRAWING NUMBER:	REV:	
1367-SY-GA-300	B	